

Installation recommendations for Flange type bushings

Recommended Uses; Control arms, Track Bars, Push bars, Mounts, 4 Bar links, etc.

Do not used on applications that involve:

-Heat above 150 F°.

-Constant rotation.

-Excessive overloading.

Note: The actual bushing O.D. is slightly larger and the I.D. Is slightly smaller then noted in the catalog to accomodate proper pre-load.

Be sure that the eye is fully deburred and does not have a raised weld seam on the I.D.

© 2006 Energy Suspension. All rights reserved.

May not be reproduced, in any form, or by any means, without the written consent of Energy Suspension.

17495

19/MAR/07 BRH

ENERGY
SUSPENSION 

1131 VIA CALLEJON, SAN CLEMENTE, CA 92673

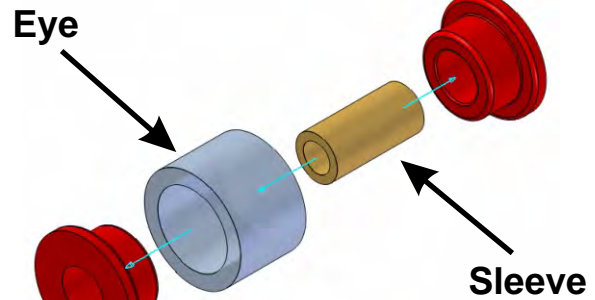

Installation recommendations for Flange type bushings

Recommended Uses; Control arms, Track Bars, Push bars, Mounts, 4 Bar links, etc.

Do not used on applications that involve:

-Heat above 150 F°.

-Constant rotation.

-Excessive overloading.

Note: The actual bushing O.D. is slightly larger and the I.D. Is slightly smaller then noted in the catalog to accomodate proper pre-load.

Be sure that the eye is fully deburred and does not have a raised weld seam on the I.D.

© 2006 Energy Suspension. All rights reserved.

May not be reproduced, in any form, or by any means, without the written consent of Energy Suspension.

17495

19/MAR/07 BRH

ENERGY
SUSPENSION 

1131 VIA CALLEJON, SAN CLEMENTE, CA 92673

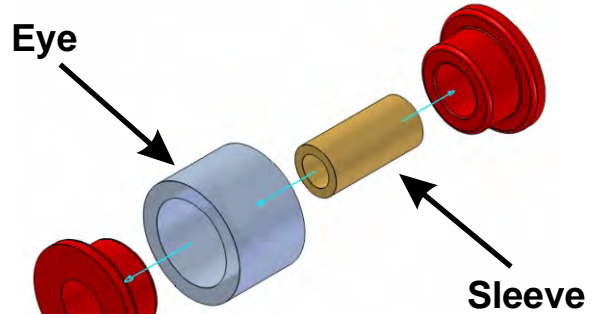

Installation recommendations for Flange type bushings

Recommended Uses; Control arms, Track Bars, Push bars, Mounts, 4 Bar links, etc.

Do not used on applications that involve:

-Heat above 150 F°.

-Constant rotation.

-Excessive overloading.

Note: The actual bushing O.D. is slightly larger and the I.D. Is slightly smaller then noted in the catalog to accomodate proper pre-load.

Be sure that the eye is fully deburred and does not have a raised weld seam on the I.D.

© 2006 Energy Suspension. All rights reserved.

May not be reproduced, in any form, or by any means, without the written consent of Energy Suspension.

17495

19/MAR/07 BRH

ENERGY
SUSPENSION 

1131 VIA CALLEJON, SAN CLEMENTE, CA 92673

