

S6206AL

2003-2007 FORD F250/350, 6.0L POWERSTROKE,
TURBO BACK (STOCK CAT), 4" SINGLE SIDE

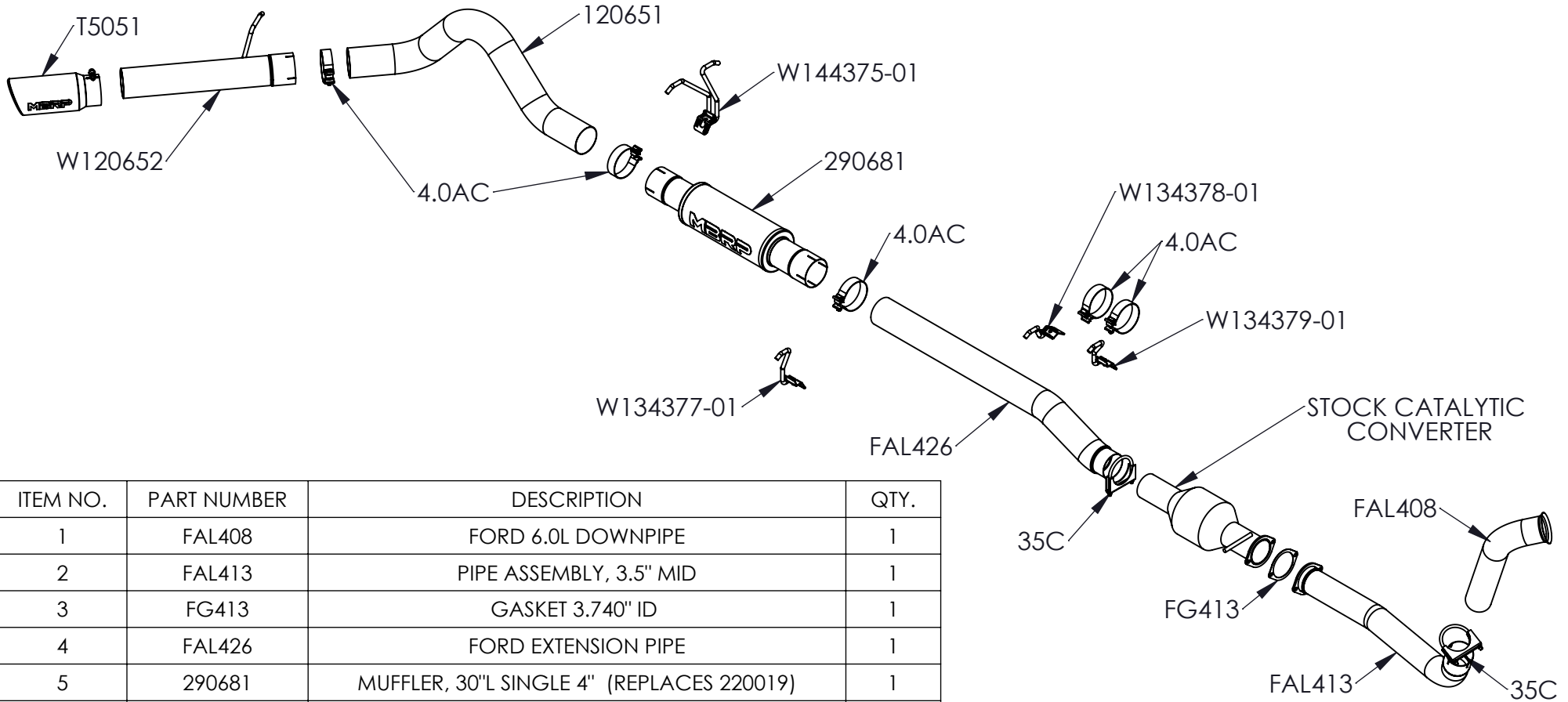

| ITEM NO. | PART NUMBER | DESCRIPTION | QTY. |
|----------|-------------|--|------|
| 1 | FAL408 | FORD 6.0L DOWNPIPE | 1 |
| 2 | FAL413 | PIPE ASSEMBLY, 3.5" MID | 1 |
| 3 | FG413 | GASKET 3.740" ID | 1 |
| 4 | FAL426 | FORD EXTENSION PIPE | 1 |
| 5 | 290681 | MUFFLER, 30"L SINGLE 4" (REPLACES 220019) | 1 |
| 6 | 120651 | OVER AXLE PIPE (2PC F425) | 1 |
| 7 | W120652 | PIPE, TAIL 4" ASSEMBLY (2PC F425) | 1 |
| 8 | 35C | 3 1/2" CLAMP | 2 |
| 9 | 4.0AC | CLAMP, 4" BAND, ALUMINIZED STEEL | 5 |
| 10 | W134379-01 | HANGER ASSY, HANG TIGHT™, 1/2" | 1 |
| 11 | W134378-01 | HANGER ASSY, HANG TIGHT™, 1/2" | 1 |
| 12 | W134377-01 | HANGER ASSY, HANG TIGHT™, 1/2" | 1 |
| 13 | W144375-01 | HANGER ASSY, HANG TIGHT™, DUAL 1/2" | 1 |
| 14 | T5051 | TIP, 4" IN, 5" OD SINGLE WALL TIP ROLLED LIP | 1 |

November 25, 2020
REV:J

MBRP