

# S6212PLM

2003-2007 FORD F250/350, 6.0L POWERSTROKE EXCLUDES REGULAR CAB, TURBO BACK, (RETAINS FACTORY OR APPROVED CAT ) 4" SINGLE SIDE

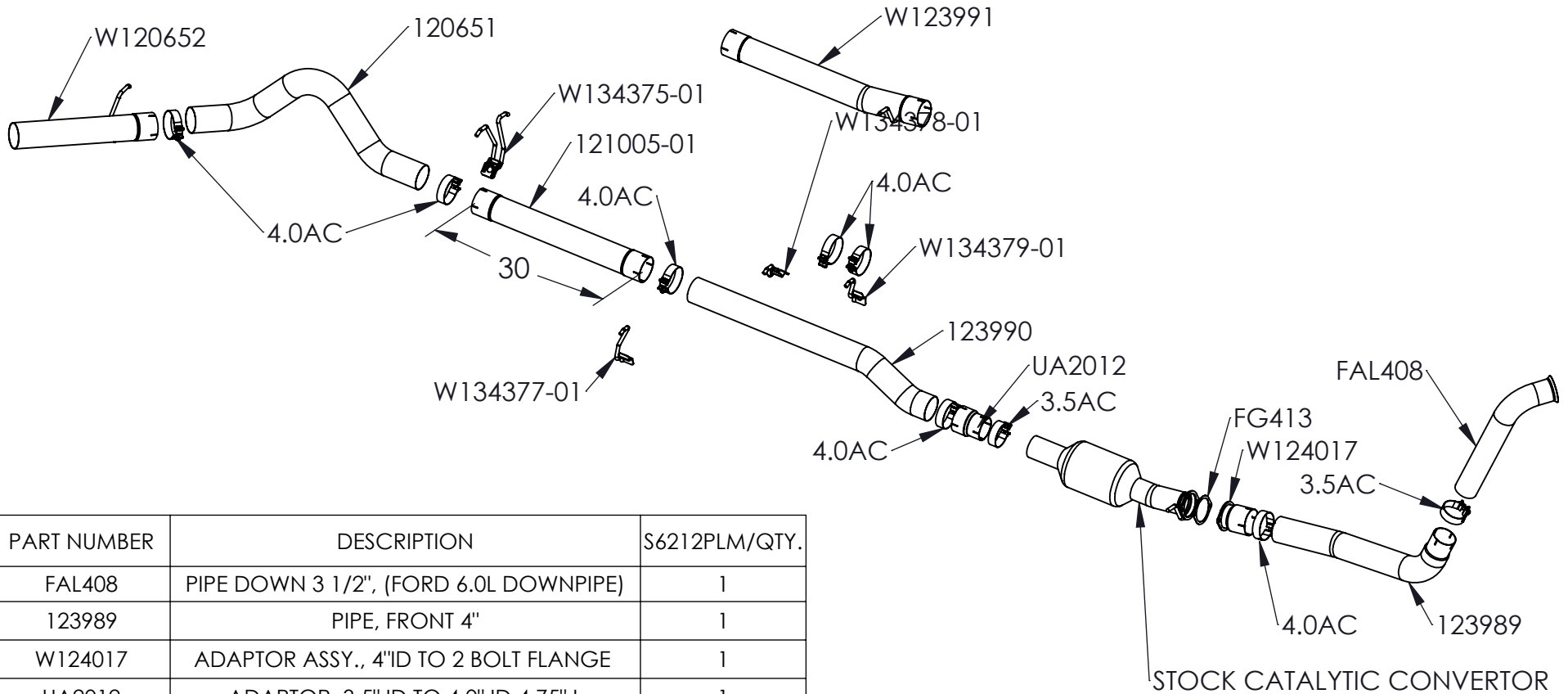

ITEM NO.	PART NUMBER	DESCRIPTION	S6212PLM/QTY.
1	FAL408	PIPE DOWN 3 1/2", (FORD 6.0L DOWNPIPE)	1
2	123989	PIPE, FRONT 4"	1
3	W124017	ADAPTOR ASSY., 4"ID TO 2 BOLT FLANGE	1
4	UA2012	ADAPTOR, 3.5" ID TO 4.0" ID 4.75" L	1
5	123990	PIPE, EXTENSION 4"	1
6	W123991	PIPE ASSEMBLY, 4"	1
7	121005-01	MUFFLER DELETE 30"	1
8	120651	OVER AXLE PIPE (2PC F425)	1
9	W120652	PIPE, TAIL 4" ASSEMBLY (2PC F425)	1
10	FG413	GASKET 3.740" ID	1
11	3.5AC	CLAMP, 3.5" BAND, ALUMINIZED STEEL	2
12	4.0AC	CLAMP, 4" BAND, ALUMINIZED STEEL	7
13	W134379-01	HANGER ASSY, HANG TIGHT™, 1/2"	1
14	W134378-01	HANGER ASSY, HANG TIGHT™, 1/2"	1
15	W134377-01	HANGER ASSY, HANG TIGHT™, 1/2"	1
16	W134375-01	HANGER ASSY, HANG TIGHT™, DUAL 1/2"	1

February 12, 2021  
REV:L

**MBRP**