



# FITTING INSTRUCTIONS

Part Number: **2838010**  
Product **RECOVERY POINT 8000kg rated**  
Description:  
Suited to **NISSAN NAVARA NP300 (D23) '15 On (fitted with ARB bull bar)**  
vehicle/s:

## WARNING

### REGARDING VEHICLES EQUIPPED WITH SRS AIRBAG:

When installed in accordance with these instructions, recovery point does not affect operation of the SRS airbag.

### ALSO, NOTE THE FOLLOWING:

- ◆ This product must be installed exactly as per these instructions using only the hardware supplied.
- ◆ Do not use this product for any vehicle make or model, other than those specified by ARB.
- ◆ Do not remove labels included in recovery point kit.
- ◆ This product or its fixing must not be modified in any way.
- ◆ The installation of this product may require the use of specialized tools and/or techniques
- ◆ It is recommended that this product is only installed by trained personnel
- ◆ These instructions are correct as at the publication date. ARB Corporation Ltd. cannot be held responsible for the impact of any changes subsequently made by the vehicle manufacturer
- ◆ During installation, it is the duty of the installer to check correct operation/clearances of all components
- ◆ Work safely at all times
- ◆ Unless otherwise instructed, tighten fasteners to specified torque

## **ARB 4x4 ACCESSORIES**

Corporate Head Office

42-44 Garden St  
Kilsyth, Victoria  
AUSTRALIA 3137

Tel: +61 (3) 9761 6622  
Fax: +61 (3) 9761 6807

Australian enquiries  
North & South American enquiries  
Other international enquiries

sales@arb.com.au  
sales@arbusa.com  
exports@arb.com.au

**www.arb.com.au**

# IMPORTANT INFORMATION. GENERAL CARE AND MAINTENANCE

By choosing an ARB Recovery Point, you have bought a product that is one of the most sought after 4WD products in the world. Your recovery point is a properly engineered, reliable, quality accessory that represents excellent value. To keep your recovery point in original condition it is important to care and maintain it following these recommendations:



As part of any Pre Trip Preparation, or on an annual basis, it is recommended that a thorough visual inspection of the recovery point is carried out, making sure that all bolts and other components are torqued to the correct specification. Replace any components as necessary. This service can be performed by your local authorised ARB Stockist.

## FITTING REQUIREMENTS

### REQUIRED TOOLS FOR FITMENT OF PRODUCT:

TORQUE WRENCH (9-89Nm)	BASIC TOOL KIT
ANGLE GRINDER WITH CUTTING DISC	

### HAVE AVAILABLE THESE SAFETY ITEMS WHEN FITTING PRODUCT:

<b>Protective eyewear</b>		<b>Hearing protection</b>	
---------------------------	---	---------------------------	---

**NOTE: 'WARNING' notes in the fitting procedure relate to OHS situations, where to avoid a potentially hazardous situation it is suggested that protective safety gear be worn or a safe work procedure be employed. If these notes and warnings are not heeded, injury may result.**

### FASTENER TORQUE SETTINGS:

SIZE	Torque Nm	Torque lbft
M6	9Nm	7lbft
M8	22Nm	16lbft
M10	44Nm	32lbft
M12x1.25	89Nm	65lbft

## PARTS LISTING

APPLICATION.	PART NO.	QTY	DESCRIPTION
FIT RECOVERY POINT	3759645	1	RECOVERY POINT NISSAN NAVARA
	6151204	2	BOLT M10 x 1.5 x 35 Gd 8.8 BZ
	6151232	2	BOLT M10 x 1.5 x 30 Gd 8.8 ZP
	4581048	4	WASHER SPRING M10
	4581040	4	WASHER FLAT M10
	6151321	4	NUT FLANGE M10 x 1.5
	4581007	1	WASHER SPACER M12
SAFETY	2125484	1	RECOVERY POINT WARNING LABEL
	211433	1	VEHICLE RECOVERY BOOKLET
	211512	1	OPERATIONS INSTRUCTION CARD

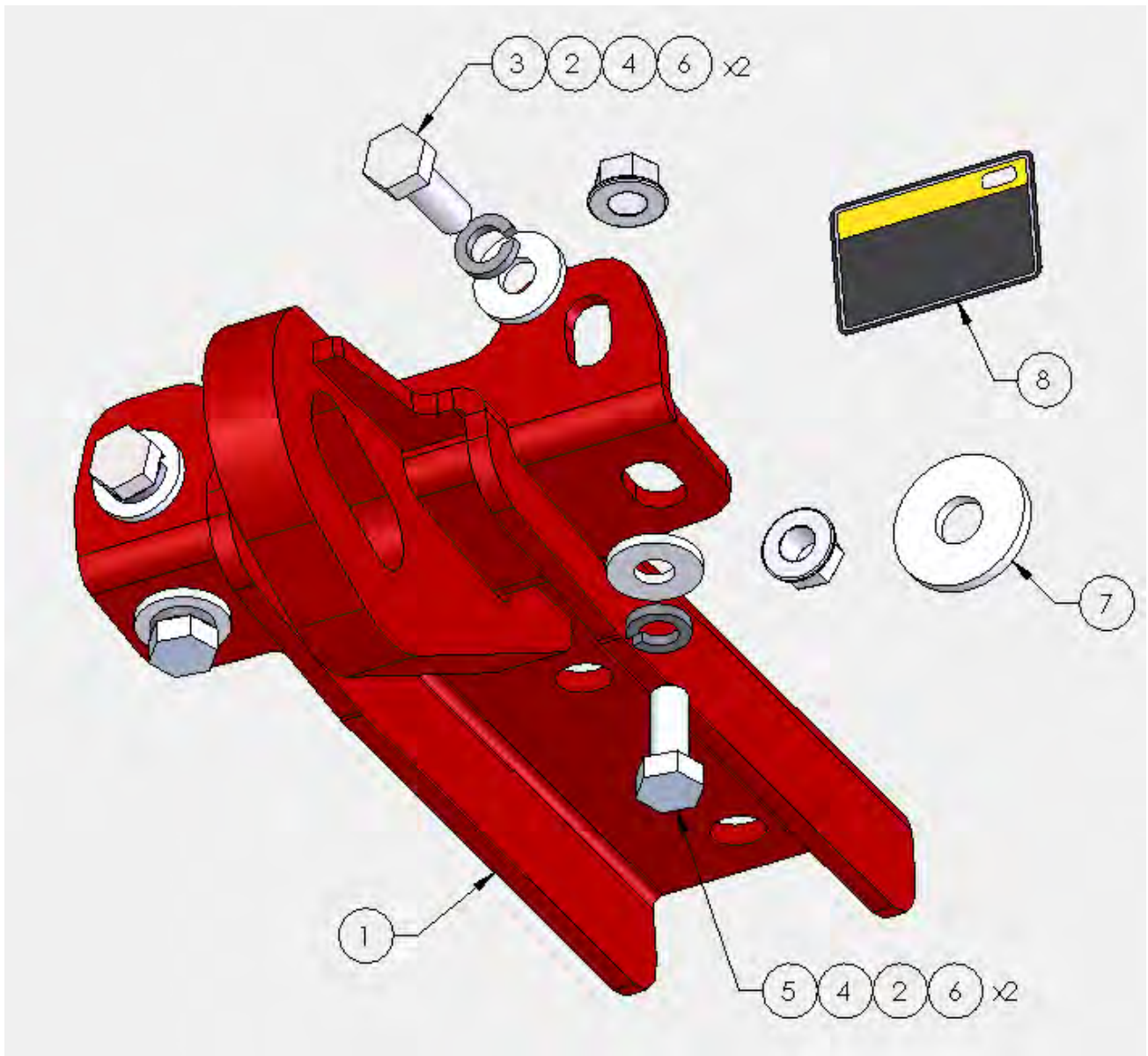

## FITTING PROCEDURE – LH fitment with ARB bull bar

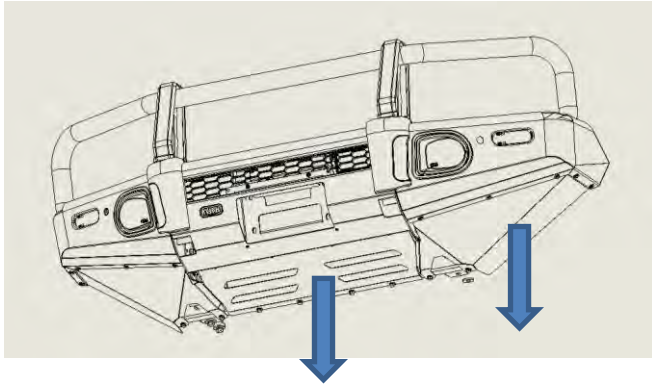

1. Remove wing under panel, ARB stone guard and OEM stone shield from bull bar.

Retain M6 fasteners, M8 fasteners relating to OEM stone shield and dispose remaining M8 fasteners.

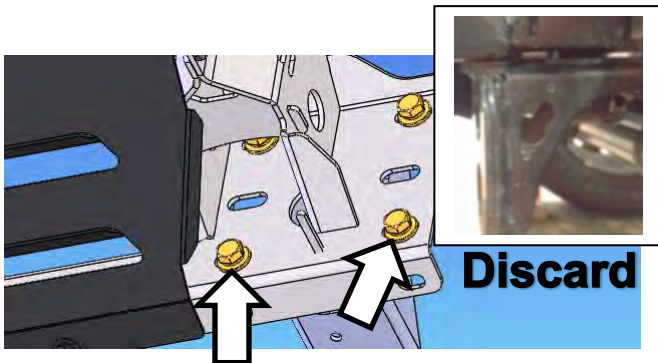

2. Remove 2x M10 fasteners located in lower section of bull bar mount assembly, 2x M12 OEM bolts, M12 washer and OEM tow hook

Retain 2x M12 OEM bolts, 1x M12 washer used to space OEM tow hook at rear and M10 washers which were located between mount assembly and chassis bracket (keep washers in same position)

Dispose of OEM tow hook and 2x SEMS M10 x 1.5 x 30mm bolts.

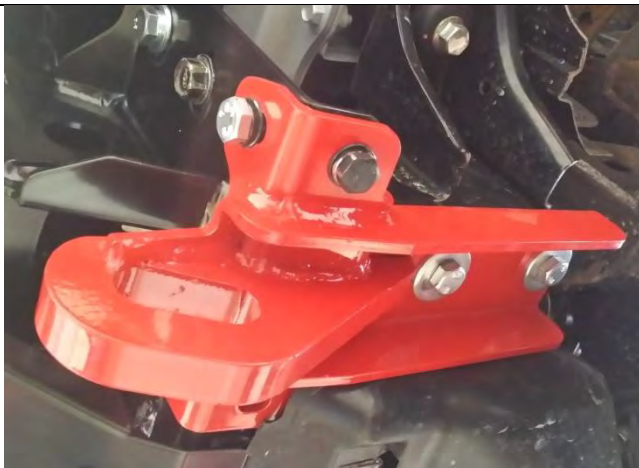

3. Fasten recovery point to bull bar and chassis using retained 2x M12 bolts, 2x M10x1.5x30mm bolts, 2x M10x1.5x25mm bolts, 4x M10 flat washers, 4x M10 spring washers and 4x M10x1.5 flange nuts.

**Note:** Add M12 washer at rear between recovery point and chassis to space out.

Tighten M10 fasteners first, followed by M12 fasteners to specified torque.



M12x1.25 – 89Nm



M10x1.5 – 44Nm

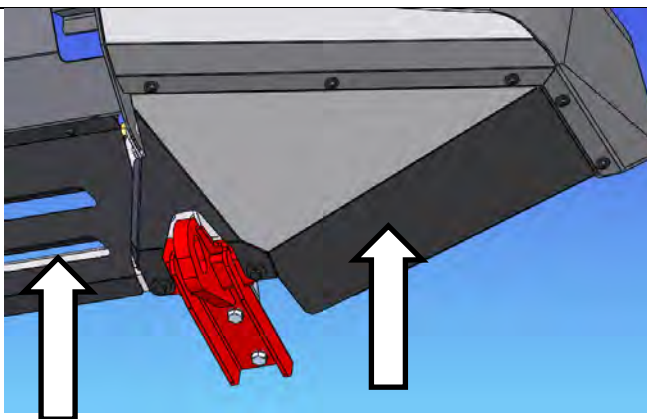

4. Fasten wing under panel and stone guard back to bull bar using M6 fasteners retained from Step 1 and 2x M10x1.5x25mm bolts, 2x M10 flat washers, 2x M10 spring washers and 2x M10x1.5 flange nuts supplied in kit.

5. Re-fit OEM stone shield.

**Note:** OEM plastic stone shield will rest up against recovery point when back in position. Dispose of any remaining fasteners.



M6 – 9Nm



M10x1.5 – 44Nm

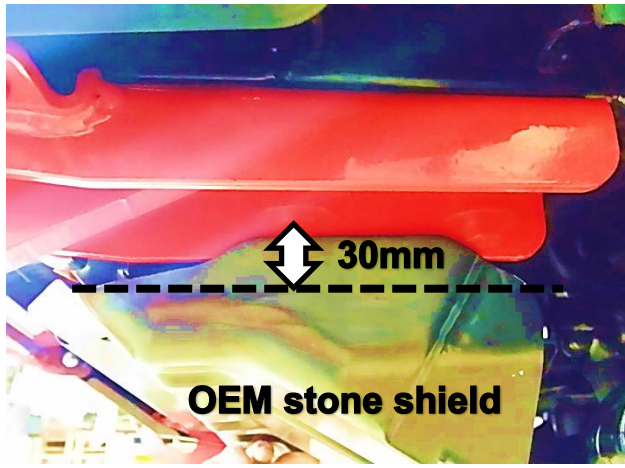

6. If OEM stone shield is steel, mark and cut out flange section as shown to allow for clearance to recovery point using an angle grinder with cutting disc.
7. Touch up cut edges with anti-corrosive spray paint.



**Warning:** Drilling operations can result in flying metal debris, safety glasses should be worn.



8. Add recovery point warning label onto wing under panel as shown.

### FITTING PROCEDURE – RH fitment with ARB bull bar

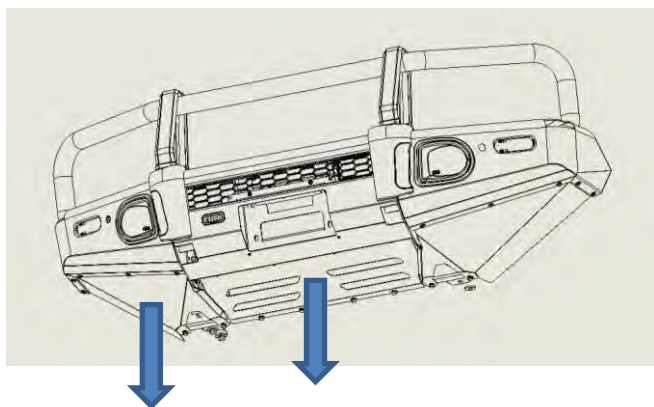

1. Remove wing under panel, ARB stone guard and OEM stone shield from bull bar.

Retain M6 fasteners, M8 fasteners relating to OEM stone shield and dispose remaining M8 fasteners.

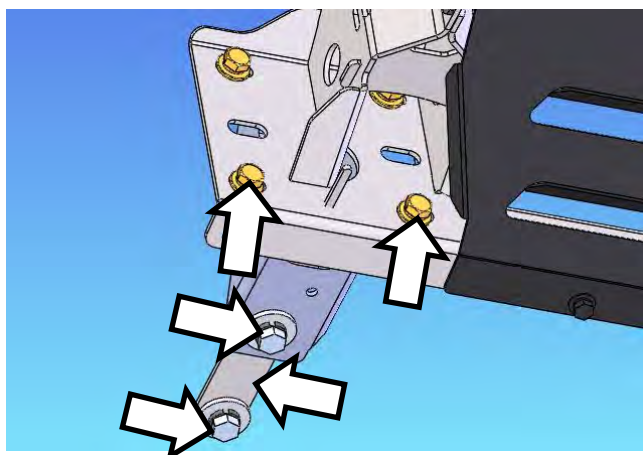

2. Remove 2x M10 fasteners located in lower section of bull bar mount assembly and 2x M12 fasteners.

Retain M12 fasteners, M12 nut plate and M10 washers which were located between mount assembly and chassis bracket (keep washers in same position).

Dispose of 2x SEMS M10 x 1.5 x 30mm bolts.



- Fasten recovery point to bull bar and chassis using retained 2x M12 bolts, 2x M10x1.5x30mm bolts, 2x M10x1.5x25mm bolts, 4x M10 flat washers, 4x M10 spring washers, 4x M10x1.5 flange nut and retained M12 nut plate.

**Note:** Add M12 washer at rear between recovery point and chassis to space out.

Tighten M10 fasteners first, followed by M12 and tighten to specified torque.



M12x1.25 – 89Nm



M10x1.5 – 44Nm

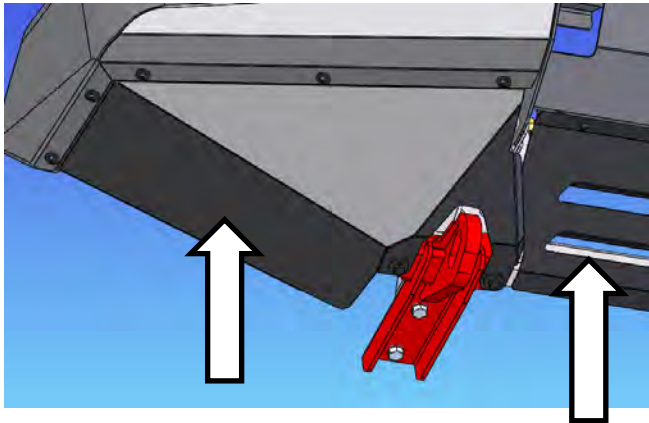

- Fasten wing under panel and stone guard back to bull bar using M6 fasteners retained from Step 1 and 2x M10x1.5x25mm bolts, 2x M10 flat washers, 2x M10 spring washers and 2x M10x1.5 flange nuts.

- Re-fit OEM stone shield.

**Note:** OEM plastic stone shield will rest up against recovery point when back in position. Dispose of any remaining fasteners.



M6 – 9Nm



M10x1.5 – 44Nm

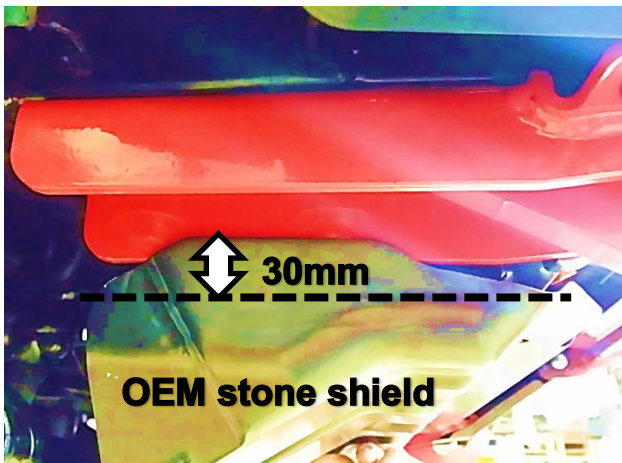

- If OEM stone shield is steel, mark and cut out flange section as shown to allow for clearance to recovery point using an angle grinder with cutting disc.

- Touch up cut edges with anti-corrosive spray paint.



**Warning:** Drilling operations can result in flying metal debris, safety glasses should be worn.



- Add recovery point warning label onto wing under panel as shown.

## FITTED PRODUCT – Recovery Point (LH & RH) Navara NP300 (D23)

